

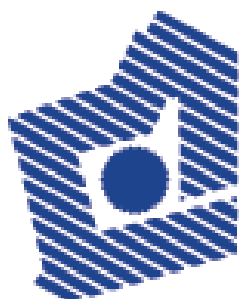

 **CABINETS**



**WEST AUSTRALIAN
OWNED & OPERATED
MANUFACTURING**

alpine

Quick Quality Cabinets

Welcome to the Alpine Q Family!

Thank you for your purchase of our Alpine Q cabinets, the quicker way to your dream space. We understand that embarking on a home improvement project can be both exciting and daunting, that's why we've designed our Alpine Q cabinets to streamline the process, delivering pre-assembled quality directly to your doorstep.

You've made a smart choice by selecting Alpine Q, and we're committed to ensuring your installation is as smooth and satisfying as possible. With the bulk of the assembly already completed, you're well on your way to transforming your space.

This guide is designed to complement your pre-assembled cabinets, providing you with valuable tips and techniques to achieve professional-looking results. We'll walk you through the essential steps, ensuring a seamless and enjoyable installation experience.

Inside this guide, you'll find instructions on:

- Removing doors using the quick-release hinges
- Removing drawers from the runners
- Implementing reversible door opening options
- Installing and adjusting the cabinet feet
- Installing the kickrail
- Adjusting hinges to align the doors
- Installing the handles
- Contact information for support

We believe in the quality and simplicity of our Alpine Q cabinets, and we're confident that with this guide, you'll be able to create the dream space you've always envisioned.

Your satisfaction is our priority.

We're thrilled to be a part of your home improvement journey. Please take a moment to review the contents of this guide before beginning your installation. If you have any questions or require further assistance, don't hesitate to reach out to our customer support team.

We wish you all the best in creating your beautiful, functional space with Alpine Q cabinets.

Sincerely,

The Alpine Q Team.

Quick Release Door Hinges



Quick Release Cabinet Hinges: Door Removal and Installation

Our Alpine Q cabinets feature quick-release hinges for easy door removal and installation. This eliminates the need for tools, simplifying both installation and future maintenance.

To Remove a Door:

Open the cabinet door fully.

Locate the release lever or button on the hinge as pictured above

Press or slide the release lever/button.

Gently pull the door away from the cabinet. The hinge will separate, and the door will detach.

To Install a Door:

Align the hinge parts on the door with the corresponding parts on the cabinet.

Push the door towards the cabinet until you hear a “click.” This indicates the hinge has snapped together securely.

Ensure the door is firmly attached by gently trying to pull it away.

Close and open the door to verify proper alignment and function.

Troubleshooting:

Door won't release: Ensure the release mechanism is fully engaged. Try applying firm, even pressure.

Door won't snap on: Check for obstructions. Ensure the hinge parts are aligned correctly.

Drawer Removal

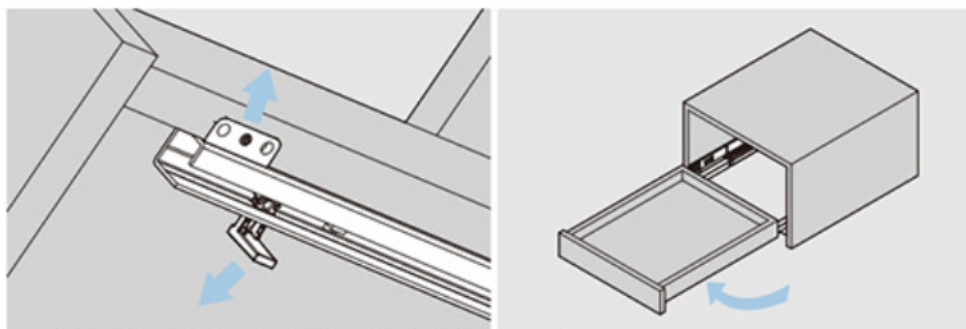

Drawer Removal and Installation

Drawer Removal:

Fully Extend the Drawer: Pull the drawer out to its maximum extension.

Locate the Release Levers/Clips: On each side of the drawer, near the front, you'll find release clips

Activate the Release Clips by pushing them towards the middle of the drawer

Pull the Drawer Out: Gently pull the drawer front slightly upwards and straight out from the runners. The drawer should slide off smoothly.

Drawer Installation:

Fully Extend the Runners: Pull the drawer runners out from the cabinet to their maximum extension.

Align the Drawer with the Runners: Position the drawer so that the drawer slides align with the runners inside the cabinet.

Slide the Drawer Onto the Runners: Carefully slide the drawer onto the runners, ensuring the runners engage properly.

Push the Drawer Levers/Clips: Push the locking clips fully inward until you hear or feel a "click," indicating that the drawer is securely locked onto the runners.

Test the Drawer Operation: Open and close the drawer several times to confirm smooth operation and proper soft-close functionality.

Reversible Door Opening



Customize Your Cabinet Layout: Reversible Door Functionality

Alpine Q cabinets when needed are engineered with reversible door options. This means you can choose whether your cabinet doors open from the left or right, allowing you to perfectly adapt to your room's layout and personal preferences.

The top and bottom panels of these cabinets are identical. This eliminates any 'right-side-up' orientation, giving you maximum freedom in positioning your cabinets.

Simply decide on your desired door swing and install accordingly.

Choose Your Swing: Left or right-hand door opening to suit your space.



Adjustable Feet Installation



Installing Adjustable Cabinet Feet

Our Alpine Q cabinets come with adjustable feet to ensure level installation on any surface. Follow these steps to attach them:

Prepare the Cabinet: Lay the cabinet carefully on its back. This provides easy access to the underside.

Locate Pilot Holes: On the bottom of the cabinet, you will find four pre-drilled pilot holes for each foot. These holes indicate the precise positioning for the foot's base plate.

Attach the Base Plates: Using the supplied screws, securely fasten the base plate of each foot to the bottom of the cabinet at each corner. Ensure the screws are tightened firmly.

Insert the Feet: Once the base plates are attached, simply push the adjustable feet into the base plates until they lock into place.

Carefully stand the cabinet upright and place into position.

Adjusting Cabinet Height



Adjusting Cabinet Height for Perfect Leveling

After installing the adjustable feet, you can easily fine-tune the height of your Alpine Q cabinets to ensure a perfectly level installation.

Locate the Adjustment Mechanism: The bottom section of each foot is designed for height adjustment.

Rotate for Height Adjustment:

Clockwise Rotation: Turning the bottom of the foot clockwise will raise the cabinet.

Counterclockwise Rotation: Turning the bottom of the foot counterclockwise will lower the cabinet.

Adjustment Range: The adjustable feet provide a height range of 145mm to 175mm.

Kickrail Consideration: Consider the height of your Alpine Q kickrail, which is manufactured to 150mm.

Adjust the feet to ensure the cabinet's base aligns correctly with the kickrail for a seamless finish.

Use a spirit level to ensure the cabinet is perfectly level on all sides.

Adjust the feet as needed until the cabinet is level.

Kickrail Installation

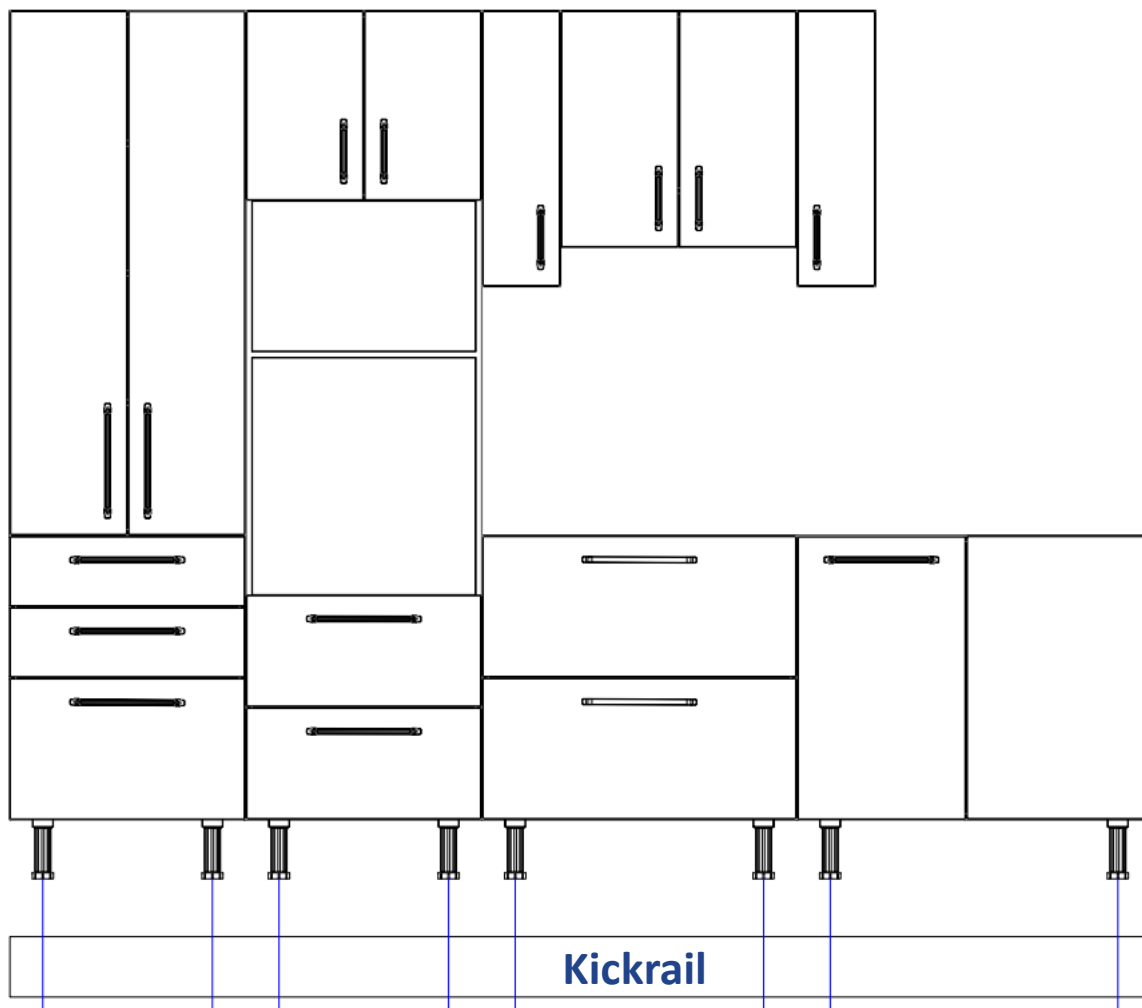

Adjustable Clips

Installing Your Alpine Q Kickrail with Adjustable Clips

Our Alpine Q cabinets utilize a simple and effective adjustable clip system for kickrail installation.

Follow these steps to achieve a seamless finish:

Prepare the Kickrail: Lay the kickrail face down in front of your installed cabinets.

Mark Foot Positions: Carefully mark the exact positions of each cabinet foot on the back of the kickrail using a pencil. This ensures precise clip placement.

Attach Adjustable Clips: For each marked foot position, securely screw an adjustable clip to the back of the kickrail. Use the provided screws and ensure the clips are firmly attached.

Clip the Kickrail in Place: With the clips now attached to the kickrail, simply clip the kickrail onto the corresponding cabinet feet.

The clips are designed to securely lock the kickrail in place.

Hinge Adjustment

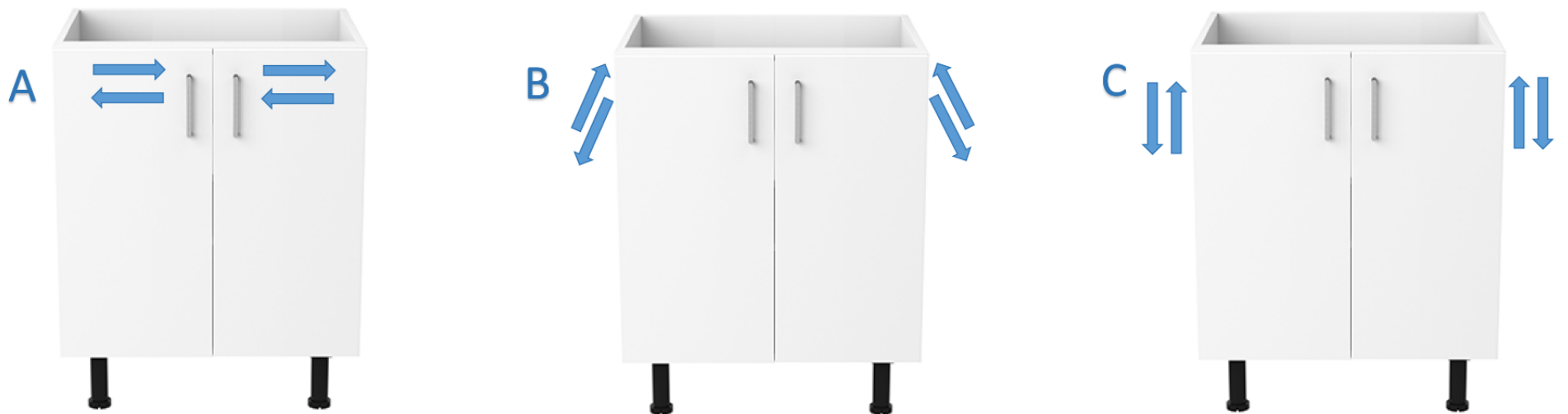

Perfect Door Alignment: Adjusting Your Cabinet Hinges

Our Alpine Q cabinets are equipped with adjustable hinges to ensure your doors align perfectly. Follow these steps to fine-tune your door positioning:

Understanding the Adjustment Screws (Refer to the Image):

Side-to-Side Adjustment (Horizontal): The screw closest to the door edge adjusts the door's position left or right.

Up-and-Down Adjustment (Vertical): The screw in the middle adjusts the door's position up or down.

In-and-Out Adjustment (Depth): The screw furthest from the door edge adjusts the door's depth, bringing it closer to or further from the cabinet frame.

Adjusting Your Cabinet Doors:

Open and close the cabinet door to determine which direction it needs to be adjusted.

Side-to-Side: If the door is too far to the left or right, adjust the horizontal screw.

Up-and-Down: If the door is too high or too low, adjust the vertical screw.

In-and-Out: If the door is too close or too far from the cabinet frame, adjust the depth screw.

Make Small Adjustments: Use a Phillips head screwdriver to turn the appropriate screw.

Make small adjustments (a quarter or half turn at a time) to avoid over-adjusting.

Test the Door: After each adjustment, close and open the door to check the alignment.

Repeat as Necessary: Continue adjusting the screws until the door is perfectly aligned.

Adjust All Hinges: Doors have multiple hinges, adjust each hinge as needed to achieve a uniform alignment.

Handle Installation

Installing Your Alpine Q Cabinet Handles with Precision

Adding handles to your Alpine Q cabinet doors is a simple process thanks to our included drilling jig. Follow these steps for a professional and consistent finish:

What's Included:

Alpine Q Handles (quantity as per your order)
Handle Fixing Screws (appropriate length for your doors)
Drilling Jig (plastic, with pre-drilled holes at 128mm centers)
5mm Drill Bit

Installation Steps:

Identify Door Type: Determine if you are working on a base cabinet door or a wall cabinet door.

Position the Jig:

Base Cabinet Doors: Slide the plastic drilling jig over the top edge of the door. Ensure it sits flush against the door surface.

Wall Cabinet Doors: Slide the plastic drilling jig over the bottom edge of the door, ensuring it sits flush.

Locate Drill Points: The jig has pre-drilled holes spaced at 128mm – the precise distance required for your Alpine Q handles. These holes will guide your drilling.

Drill Pilot Holes (Recommended):

Using the supplied 5mm drill bit, and guided by one of the jig's holes, carefully drill a small pilot hole into the front surface of the door.

Flip the door over or open and repeat. Drill another small pilot hole from the back surface.

This technique helps prevent chipping and ensures a clean hole.

Drill Through Holes:

Align the 5mm drill bit with one of the pilot holes (either front or back).

Keeping the drill level and straight, carefully drill completely through the door.

Repeat this process for the second pilot hole, ensuring the drill remains level. You should now have two clean, parallel 5mm holes for each handle.

Attach the Handle:

Position the handle over the drilled holes on the door.

Insert the supplied handle fixing screws through the drilled holes in the door and into the holes in the handle.

Tighten the screws firmly using a screwdriver, impact drivers and drills are too strong for this application.

Be careful not to overtighten, which could damage the door.

Repeat for Remaining Doors: Follow the same steps for all other cabinet doors that require handles.

Tips for Success:

Take Your Time: Drilling should be done carefully and steadily.

Keep the Drill Level: Maintaining a level drill is crucial for accurate hole alignment.

Pilot Holes are Key: Don't skip the pilot hole step for the cleanest results.

Gentle Tightening: Avoid overtightening the handle screws.

By following these instructions, you'll be able to easily and accurately install the handles on your Alpine Q cabinet doors, adding the perfect finishing touch to your new space.

Handle Installation



Base Units

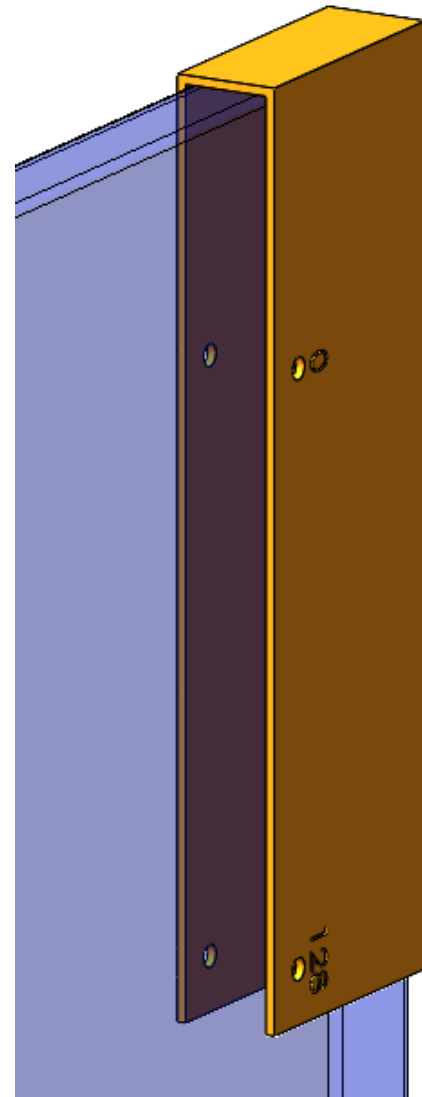

Wall Units

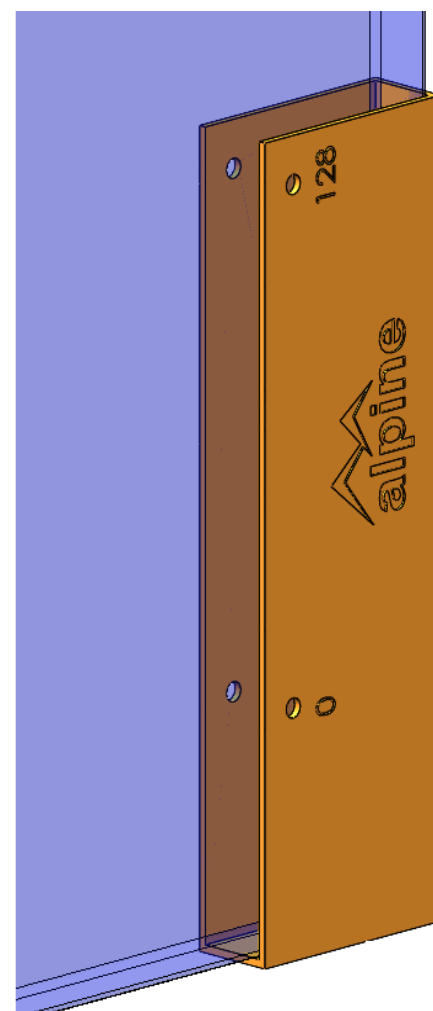

DESIGNING FOR THE FUTURE



WEST AUSTRALIAN
OWNED & OPERATED
MANUFACTURING



08 6278 4996 (AlpineKB Australia)



alpinekb.au



alpinekb.com



info@alpinekb.com.au



14 Scott St, Guildford, WA 6055

Dasong Road, Zhanqi Town Yinzhou District, Ningbo

CONTACT US